

Technical data sheet



Product features

Cooking range solid top gas 5x burner on open cabinet

| | | |
|--------------|-----------------|----------|
| Model | SAP Code | 00018740 |
|--------------|-----------------|----------|



- Device type: Gas unit
- Power consumption of the zone 1 [kW]: 4
- Power consumption of the zone 2 [kW]: 8,5
- Power consumption of the zone 3 [kW]: 6,6
- Power consumption of the zone 4 [kW]: 8,5
- Power consumption of the zone 5 [kW]: 8,5
- Ignition: Piezo
- Protection of controls: IPX4
- Material: AISI 304 top plate and cladding

| | | | |
|------------------------|--------------------------------|---|-----|
| SAP Code | 00018740 | Number of zones | 5 |
| Net Width [mm] | 1200 | Power consumption of the zone 1 [kW] | 4 |
| Net Depth [mm] | 700 | Power consumption of the zone 2 [kW] | 8,5 |
| Net Height [mm] | 900 | Power consumption of the zone 3 [kW] | 6,6 |
| Net Weight [kg] | 112.00 | Power consumption of the zone 4 [kW] | 8,5 |
| Power gas [kW] | 36.100 | Power consumption of the zone 5 [kW] | 8,5 |
| Type of gas | Natural gas, propane butane | | |

Technical data sheet



Technical drawing

Cooking range solid top gas 5x burner on open cabinet

| | | |
|--------------|-----------------|----------|
| Model | SAP Code | 00018740 |
|--------------|-----------------|----------|

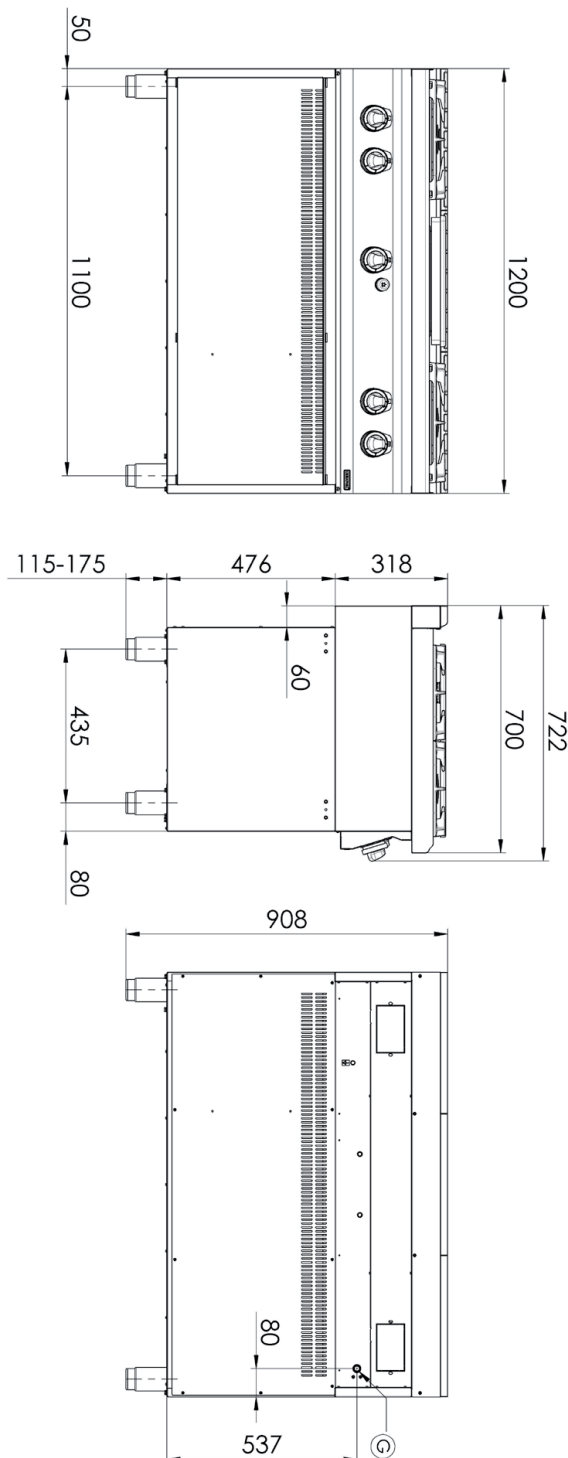

Technical data sheet



Technical parameters

Cooking range solid top gas 5x burner on open cabinet

Model

SAP Code

00018740

1. SAP Code:

00018740

2. Net Width [mm]:

1200

3. Net Depth [mm]:

700

4. Net Height [mm]:

900

5. Net Weight [kg]:

112.00

6. Gross Width [mm]:

1260

7. Gross depth [mm]:

820

8. Gross Height [mm]:

1079

9. Gross Weight [kg]:

129.00

10. Device type:

Gas unit

11. Construction type of device:

With substructure

12. Power gas [kW]:

36.100

13. Ignition:

Piezo

14. Type of gas:

Natural gas, propane butane

15. Protection of controls:

IPX4

16. Exterior color of the device:

Stainless steel

17. Material:

AISI 304 top plate and cladding

18. Indicators:

operation and warm-up

19. Worktop material:

AISI 304

20. Worktop Thickness [mm]:

1.20

21. Number of zones:

5

22. Power consumption of the zone 1 [kW]:

4

23. Power consumption of the zone 2 [kW]:

8,5

24. Power consumption of the zone 3 [kW]:

6,6

25. Power consumption of the zone 4 [kW]:

8,5

26. Power consumption of the zone 5 [kW]:

8,5

27. Safety thermocouple:

Yes

28. Adjustable feet:

Yes

Technical data sheet



Technical parameters

Cooking range solid top gas 5x burner on open cabinet

| | | |
|--------------|-----------------|----------|
| Model | SAP Code | 00018740 |
|--------------|-----------------|----------|

29. Number of burners/hot plates:

5

31. Burner type:

Brass, detachable

30. Type of gas cooking zones:

Fire protection to install + Classic burners

32. Connection to a ball valve:

1/2